



InVillages
with SIMON BANCE

invillages.com

124 Guildford Road
West End, Woking, Surrey GU24 9LT

A charming Grade II listed cottage dating back to the late 16th century, situated close to village amenities & benefitting from a wealth of period features, including exposed timbers, vaulted ceilings & feature fireplaces.

Accommodation comprises entrance hall, double aspect sitting room, dining room, country style fitted kitchen with granite worktops, range cooker with 5 ring gas burners and integrated white goods including fridge, washer/dryer & dishwasher. 3 bedrooms and re-fitted period style bathroom, double glazing, gas fired central heating. Re-fitted with oak floor boards in the main sitting room.

Outside is a front garden, driveway for 2-3 cars and attached single garage, with access to an enclosed south-west facing cottage style rear garden.

Price Guide £575,000 Freehold



VIEWING: By appointment only please through In Villages Estate Agents

Telephone: 01276 855788 sales@invillages.com

Agents Note : None of the services or appliances within the property have been tested by our company and none of the fixtures & fittings or electrical appliances, unless mentioned within our sales particulars form part of the property for sale, if you are unsure we advise you to check with your surveyor or solicitor.

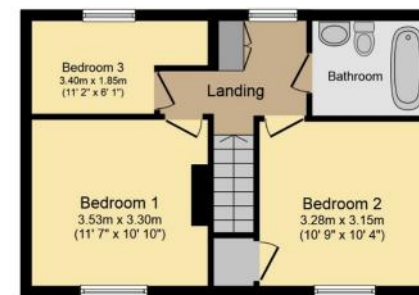

Total floor area 100.0 sq. m. (1,076 sq. ft.) approx

This plan is for illustration purposes only and may not be representative of the property.



InVillages
with SIMON BANCE

"Specialist Estate Agents for Village Property & Country Homes"

www.invillages.com

Telephone 01276 855788

38a High Street, Chobham GU24 8AA